

# Polyester wall-mounting enclosures IP 66

## Introduction



### Technical characteristics

- Monobloc wall-mounting enclosure made from polyester reinforced with fibreglass, moulded by hot compression, RAL 7032 grey colour.
- Version with transparent tempered-glass door.
- Degree of protection IP 66 according to IEC 60529.
- Resistance to external mechanical impacts:
  - Plain door enclosures IK 10 (20 joules).
  - Glazed door enclosures IK 08 (5 joules) according to IEC 62262.
- Locking device outside the sealed area, guaranteeing the tightness of IP 66 over time.
- Locking system:
  - Enclosure height ≤ 847 mm: 2 locks with double-bar insert or 1 handle with key lock and 3-point closure.
  - Enclosure height 1056 mm: 1 lock with double-bar insert and 4-point closure.
- Door opening angle: 180°.
- Bosses for accessory-fixing inserts: M6 inside the enclosure, M5 in the door for enclosure heights of 430 and 530 mm, M6 in the door for enclosure heights ≥ 647 mm.
- Fixing of rear accessories on 4 M8 studs, included in the standard supply.
- Direct fixing of symmetrical rails ref. **NSYCS●●●PLM**, with plastic nuts, ref. **NSYTCSPLM**, to be installed in the notches on the rear of the body, with a pitch of 25 mm.
- Grid pattern with a pitch of 25 mm on the back of the door.



Built-in canopy protecting the door and the sealing gasket.  
Two double-bar 3-mm locks outside the sealed zone.



Polyamide hinge pin, easily removable and captive.



External dimensions (mm)			References of wall-mounting enclosures with door			
Height (A)	Width (B)	Depth (C)	Plain (3)	Plain (1)	Transparent	Transparent (1)
430	330	200	<b>NSYPLM43</b>	<b>NSYPLM43V</b>	<b>NSYPLM43T</b>	<b>NSYPLM43TV</b>
530	430	200	<b>NSYPLM54</b>	<b>NSYPLM54V</b>	<b>NSYPLM54T</b>	<b>NSYPLM54TV</b>
647	436	250	<b>NSYPLM64</b>	<b>NSYPLM64V</b>	<b>NSYPLM64T</b>	<b>NSYPLM64TV</b>
747	536	300	<b>NSYPLM75</b>	<b>NSYPLM75V</b>	<b>NSYPLM75T</b>	<b>NSYPLM75TV</b>
847	636	300	<b>NSYPLM86</b>	<b>NSYPLM86V</b>	<b>NSYPLM86T</b>	<b>NSYPLM86TV</b>
1056	852	350	<b>NSYPLM108 (2)</b>	-	<b>NSYPLM108T (2)</b>	-

(1) Wall-mounting enclosure with handle and lock with 3-point closure and key 1242 E delivered as standard.

(2) Wall-mounting enclosure with standard 5-mm double-bar lock and lock with 4-point closure.

(3) These enclosures are also available equipped with metallic or insulating mounting plates. See summary guide of the references table on page **PLM004\_2**.

# Polyester wall-mounting enclosures IP 66

## Dimensions

A: Height  
 B: Width  
 C: Depth

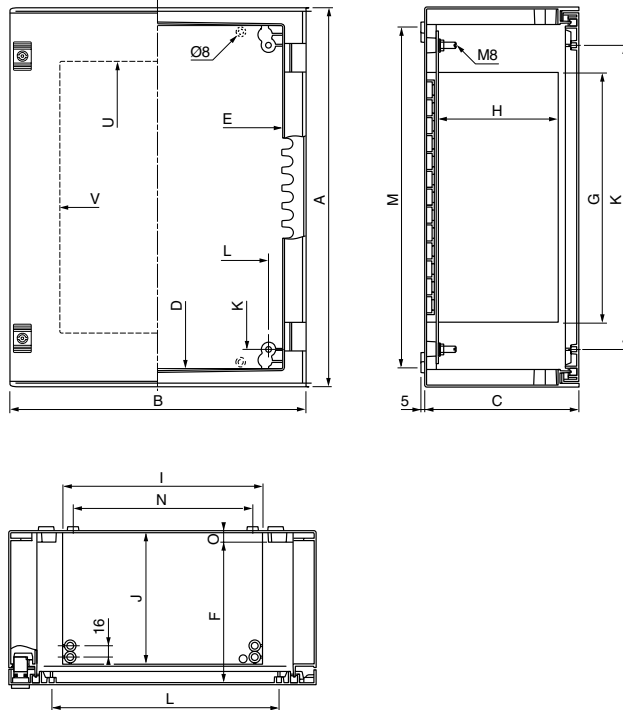

Dimensions (mm)										Bottom screw and door bosses (mm)		Internal fixing (mm)			Glazed door (mm)		References
A	B	C	D	E	F	G	H	I	J	K	L	M	N	O	U	V	
430	330	200	380	260	181	247	150	179	168	325	225	375	150	13	273	194	NSYPLM43
530	430	200	480	360	181	347	150	279	168	425	325	475	250	13	373	294	NSYPLM54
647	436	250	580	360	228	388	192	279	212	525	325	575	250	13	473	294	NSYPLM64
747	536	300	680	460	278	487	241	379	261	325	425	675	350	15	573	394	NSYPLM75
847	636	300	780	560	278	587	241	479	261	725	525	775	450	15	673	494	NSYPLM86
1056	852	350	980	760	327	775	280	680	300	925	725	975	650	15	854	661	NSYPLM108

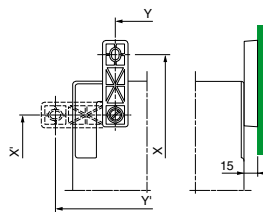

External fixing with lugs (mm)				References
Vertical		Horizontal		
X	Y	X'	Y'	
490	225	355	360	NSYPLM43
590	325	455	460	NSYPLM54
690	330	555	465	NSYPLM64
790	430	655	565	NSYPLM75
890	530	755	665	NSYPLM86
1090	750	955	885	NSYPLM108